

# KVT-W90 | Split 90° cable gland

for cables with connectors, M32/M50 / IP54



The split KVT-W90 cable glands are used to insert and seal pre-terminated cables at a 90° angle. But also electric, pneumatic or hydraulic lines without terminals or connectors as well as corrugated conduits can be easily routed (e.g. into control panels, enclosures or machinery) and sealed with IP54.

In particular, the KVT 50-W90 is perfectly suited to hold corrugated or smooth hoses. A large number of cable entry grommets is available to the user. By using [multi-hole grommets](#) up to 16 lines can be routed with one cable gland.

Polyamide standard locknuts as well as a sealing ring are included in the shipment. [Split locknuts](#) can be ordered separately.

IP54

C<sub>RU</sub>US



HL3

EN 45545-2

ECOLAB

certified



RoHS  
compliant

REACH  
COMPLIANCE

Made in  
Germany

## Specifications

IP rating (EN 60529)	IP54
Material	Polycarbonate
Flame class	UL94-V0, self-extinguishing
Operating temperature	-30 C° to 100 C°
Properties	halogen free, silicone free
Mounting options	Fasten with locknut

## Advantages & benefits

- Installation at an angle of 90° to the wall
- Routing of cables with and without connectors
- Warranty on pre-terminated cables remains
- Suitable for metric cut-outs
- Hexagonal locknut included in the delivery

## Product types & sizes

### KVT 32-W90 gy

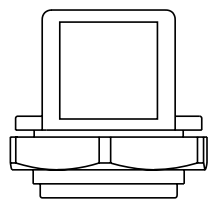

Part No.	<b>45404</b>
EAN	<b>4251269311406</b>
Package quantity	<b>10</b>
For max. no. of cables	<b>4</b>
Max. cable diameter	<b>17 mm</b>
Colour	<b>grey (similar RAL 7035)</b>
Height	<b>40 mm</b>

Mounting height	<b>26 mm</b>
Cut-out size, metric	<b>M32</b>
Cut-out size, round	<b>32,3 mm</b>
Thread	<b>M32 x 1,5</b>
Thread length	<b>11,5 mm</b>
Suitable for grommets	<b>1 x KT small</b>

### KVT 32-W90 bk

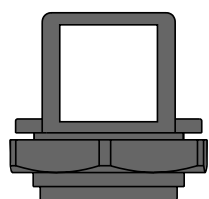

Part No.	<b>45406</b>
EAN	<b>4251269311413</b>
Package quantity	<b>10</b>
For max. no. of cables	<b>4</b>
Max. cable diameter	<b>17 mm</b>
Colour	<b>black</b>
Height	<b>40 mm</b>

Mounting height	<b>26 mm</b>
Cut-out size, metric	<b>M32</b>
Cut-out size, round	<b>32,3 mm</b>
Thread	<b>M32 x 1,5</b>
Thread length	<b>11,5 mm</b>
Suitable for grommets	<b>1 x KT small</b>

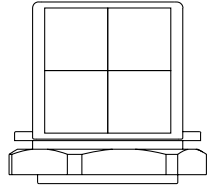
**KVT 50|4-W90 gy**

Part No.	<b>45424</b>	Mounting height	<b>46,5 mm</b>
EAN	<b>4251269311444</b>	Cut-out size, metric	<b>M50</b>
Package quantity	<b>5</b>	Cut-out size, round	<b>50,4 mm</b>
For max. no. of cables	<b>16</b>	Thread	<b>M50 × 1,5</b>
Max. cable diameter	<b>17 mm</b>	Thread length	<b>11,5 mm</b>
Colour	<b>grey (similar RAL 7035)</b>	Suitable for grommets	<b>4 x KT small</b>
Height	<b>61 mm</b>		

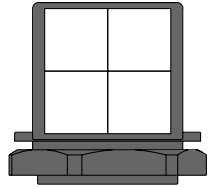
**KVT 50|4-W90 bk**

Part No.	<b>45426</b>	Mounting height	<b>46,5 mm</b>
EAN	<b>4251269311451</b>	Cut-out size, metric	<b>M50</b>
Package quantity	<b>5</b>	Cut-out size, round	<b>50,4 mm</b>
For max. no. of cables	<b>16</b>	Thread	<b>M50 × 1,5</b>
Max. cable diameter	<b>17 mm</b>	Thread length	<b>11,5 mm</b>
Colour	<b>black</b>	Suitable for grommets	<b>4 x KT small</b>
Height	<b>61 mm</b>		

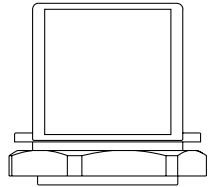
**KVT 50|1-W90 gy**

Part No.	<b>45414</b>	Mounting height	<b>46,5 mm</b>
EAN	<b>4251269311420</b>	Cut-out size, metric	<b>M50</b>
Package quantity	<b>5</b>	Cut-out size, round	<b>50,4 mm</b>
For max. no. of cables	<b>1</b>	Thread	<b>M50 × 1,5</b>
Max. cable diameter	<b>35 mm</b>	Thread length	<b>11,5 mm</b>
Colour	<b>grey (similar RAL 7035)</b>	Suitable for grommets	<b>1 x KT large</b>
Height	<b>61 mm</b>		

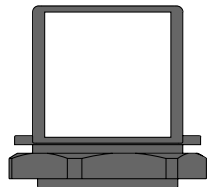
**KVT 50|1-W90 bk**

Part No.	<b>45416</b>	Mounting height	<b>46,5 mm</b>
EAN	<b>4251269311437</b>	Cut-out size, metric	<b>M50</b>
Package quantity	<b>5</b>	Cut-out size, round	<b>50,4 mm</b>
For max. no. of cables	<b>1</b>	Thread	<b>M50 × 1,5</b>
Max. cable diameter	<b>35 mm</b>	Thread length	<b>11,5 mm</b>
Colour	<b>black</b>	Suitable for grommets	<b>1 x KT large</b>
Height	<b>61 mm</b>		